

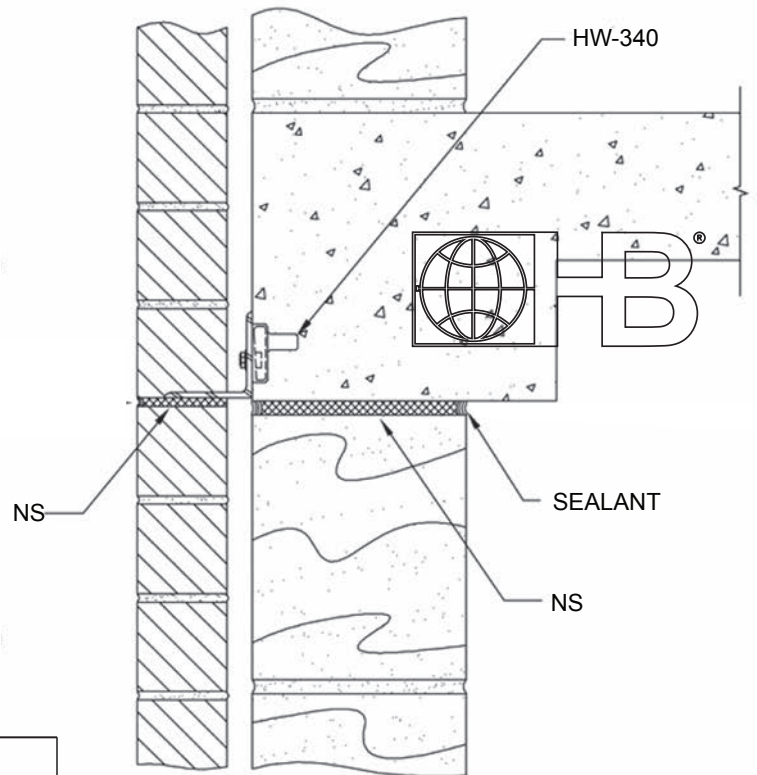

Control Joints / Expansion Joints

NS - Closed Cell Neoprene Sponge

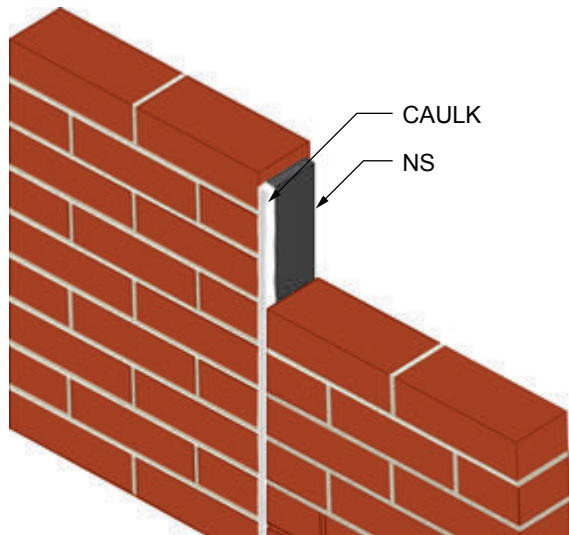

DRAWINGS FOR ILLUSTRATIVE PURPOSES ONLY

TECHNICAL DATA / PHYSICAL PROPERTIES

Color: Black / Dark Gray	
Polymer: Neoprene/SBR	
ASTM Specifications D-1056-91	SCE 41/2A1
SAE Specifications 18-R	
Tensile Strength PSI ASTM D3575	65
Density (pcf) approx.	2-5
Elongation ASTM Method 3575	350
Temperature Resistance	
Low	- 90 degrees F
High continuous	+155 degrees F
High intermittent	+210 degrees F
Compression Set (max) ASTM 3575/1056	12% / 25%
ASTM Method - 1/2" samples	
compressed 50% 22 hrs. @ 70 degrees F - 24 hr. recovery	
Compression Deflection (psi)	5 - 12
Weight required to compress a 1.129" diameter disc by 25%	
Varies according to thickness	
Accelerated Aging	
(7 days at 170o F)	
Flexibility - 180o F	Excellent
bend without cracking	
Appearance change	None
Shrinkage, Lin. Max	3% (+/-)
Water Absorption by weight	5%
(Max.) (ASTM method)	

Material:

Closed Cell (ASTM D1056 Grade 2A 1)

NS

Optional: Pressure-Sensitive Adhesive on one side

NOTE: Some configurations are non-stock, contact your local sales manager for price, availability and lead times.

Thickness:

1/4"

3/8"

1/2"

Other _____

Width:

3"

4"

6"

Other _____

IMPORTANT: Since each construction project is unique, the appropriate selection and use of any product contained herein must be determined by competent architects, engineers and other appropriate professionals who are familiar with the specific requirements of the project in question. This drawing and/or data sheet is the confidential and proprietary information of Hohmann & Barnard, Inc. and is not to be reproduced, copied or disclosed, in whole or in part, without the prior written consent of H&B.

HOHMANN & BARNARD, Inc.
CORPORATE HEADQUARTERS
 150 Motor Parkway | Suite 410
 Hauppauge, NY 11788
 TF: 800.645.0616 www.h-b.com

Branch/Subsidiary Locations:
 ALABAMA - ILLINOIS - MARYLAND
 NEW YORK - PENNSYLVANIA - TEXAS
 MARYLAND - UTAH - CANADA